

MP200 | Super-Span Thrust Beams

Thrust beams form an integral part of **Super-Span** design and construction.

These beams are not required on any other type of structure.

The overall **thrust beam** dimensions vary with the size of **Super-Span** used. The basic reinforcing detail remains unchanged.

Dimensions of **thrust beams** are available on request.

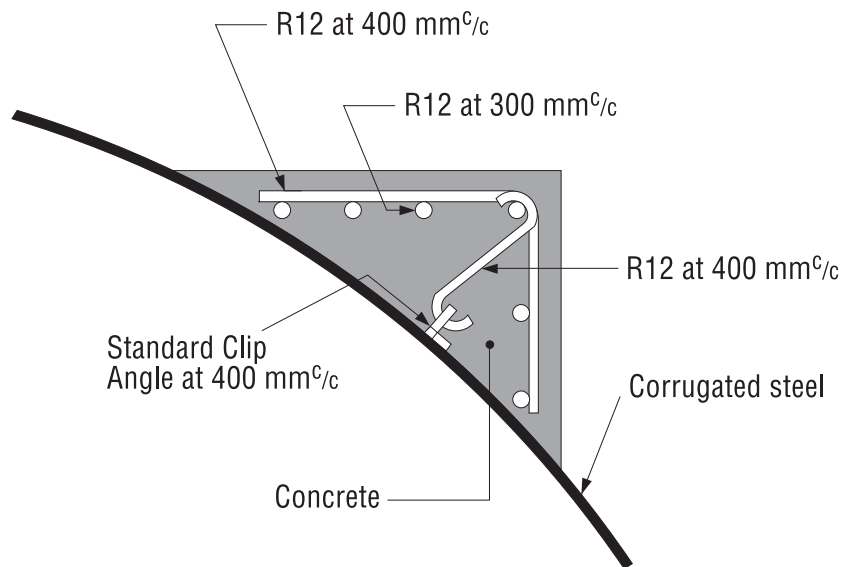

Fig. 8 - Typical thrust beam detail